

**FLEXIBILITY
& SECURITY**

COIL THREAD SECURITY BOLTS

Great for pre-cast concrete.

STANDARD-SECURITY & HIGH-SECURITY DRIVES AVAILABLE IN COIL-THREADED BOLTS

Coil Thread Security Bolts work well in pre-cast concrete forms that contain the corresponding female coil insert. The concrete grit does not affect coil threads, plus they're removable and reusable. Coil Thread Security Bolts are normally used in vaults to secure copper and telecommunications.

We carry stock in low-risk **1/2 - 6 Penta Head Standard-Security Coil Bolts** up to 3" (\$100.00 minimum). We recommend using Penta Head Coil Bolts for low-value items. Locking pliers can remove the bolts.

Special orders are available in our **High-Security Head Styles**, where only the matching tool can remove the coil bolts. We recommend using Key-Rex®, Penta-Plus™, or STYKFIT®7 for securing high-value items. Our lengths can go up to 5½."

BryKote™ is recommended.



- ▶ 1/2-6 x 2 ½ Penta Head Standard-Security Coil Bolt.

Sizes Available:

- 1/2-6 x 1 ½
- 1/2-6 x 2
- 1/2-6 x 2 ½
- 1/2-6 x 3



- ▶ **Key-Rex® Coil Security Bolt** protecting a concrete enclosure from copper wire theft.

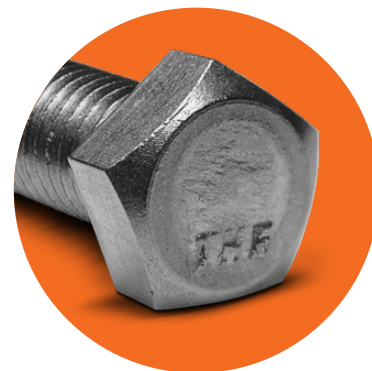

- ▶ We carry some stock in low-risk **1/2 - 6 Penta Head Standard-Security Coil Bolts**, up to 3" (\$100 min.). Call or Email for stock.



Made in USA
Engineered & Crafted
100% in the USA

WORLD'S MOST SECURE FASTENERS (800) 558-1082

BryceFastener.com

**FLEXIBILITY
& SECURITY**



COIL THREAD SECURITY BOLTS

Available in These Security Screw Drives:



Key-Rex®
Minimum Req.
Up to 5 ½" Long

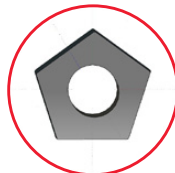

Penta-Plus™
Minimum Req.
Up to 5 ½" Long

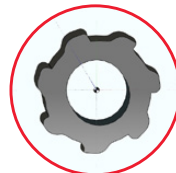

STYKFIT®7
Minimum Req.
Up to 5 ½" Long



Tam 6-Lobe™
\$100 Minimum
Up to 5 ½" Long

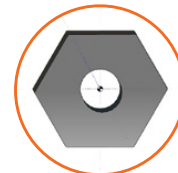

Hex-Pin
\$100 Minimum
Up to 5 ½" Long

Available in These Head Styles:



RAPTOR™ HEAD
(BHCS)
Raptor™ Head
Replaces Washer

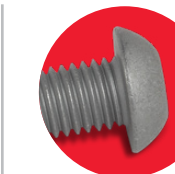





BUTTON HEAD
CAP SCREW
(BHCS)



PENTA
HEAD
Special Order
Counterbored Head

Which Security Screw Drive Do I Need?

 <p>Key-Rex®</p> <p>Elite-Security Level</p> <p>Exclusive-to-You Security Drive</p> <p>Minimums Vary</p> <p>2,500, 1,200, or 500-Piece Minimum</p>	 <p>Penta-Plus™</p> <p>High-Security Level</p> <p>Security Drive Exclusive to Bryce Customers</p> <p>Most Sizes Stocked</p> <p>Call or Email for Stock</p>	 <p>STYKFIT®7</p> <p>High-Security Level</p> <p>Fast Driving/ High Torque/ 7-Lobes</p> <p>Replaces Tam 6-Lobe™</p>	 <p>Tam 6-Lobe™</p> <p>Standard-Security Level</p> <p>Tam 6-Lobe™ Bit Tips Available at Retail</p> <p>\$100 Minimum</p>	 <p>Hex-Pin</p> <p>Standard-Security Level</p> <p>Hex-Pin Bit Tips Available at Retail</p> <p>Call or Email for Stock</p> <p>\$100 Minimum</p>
--	--	---	---	--



Made in USA
Engineered & Crafted
100% in the USA