

## Tamper-Proof Screws & Bolts (Second Only to the Key-Rex™)

Penta-Plus™ is proprietary to Bryce Fastener and configured to keep Torx®-Pin, Hex-Pin™ and other tamper-resistant bits out. Tamper-RESISTANT screws have bits sold on the open market. The higher security Penta-Plus is considered tamper-PROOF because all bits are controlled by Bryce, maintaining its integrity as a high-security fastener.

Without failure, the Penta-Plus™ has been proven tamper-proof and vandal-proof in the most extreme situations, including securing laptop computers in open kiosks, universities and city government applications. Next to the Key-Rex™, these are the most tamper-proof screws and bolts on the market. Adding the Raptor™ Claw option to the bottom of the Penta-Plus significantly increases the torque and gripping power of this screw over any other on the market except for the Key-Rex.

SECURITY LEVEL: 8

WITH RAPTOR™ CLAW OPTION: 9

## PENTA-PLUS™ MACHINE SCREWS

### Button-Head Machine Screws

NOM. Screw Size UNC.	Screw DIA. REF.	Head Diameter		Head Height		Drive Size REF.
		MAX	MIN	MAX	MIN	
2-56	.086	.164	.154	.060		P02
4-40	.112	.213	.201	.070		P04
6-32	.138	.262	.250	.085		P06
8-32	.164	.312	.298	.105		P08
10-24	.190	.361	.347	.120		P25
12-24	.211	.440	.375	.160		P25
1/4-20	.250	.437	.419	.160		P25
5/16-18	.312	.547	.527	.190		P31
3/8-16	.375	.656	.636	.225		P31
1/2-13	.500	.875	.851	.300		P50
5/8-11	.625	1.000	.970	.360		P62

### Flat-Head Machine Screws

NOM. Screw Size UNC.	Screw DIA. REF.	Head Diameter		Head Height	Drive Size REF.
		MAX	MIN		
2-56	.086	.197	.168	.064	P02
4-40	.112	.218	.255	.083	P04
6-32	.138	.263	.307	.097	P06
8-32	.164	.311	.359	.112	P08
10-24	.190	.359	.411	.127	P25
12-24	.211	.405	.425	.155	P25
1/4-20	.250	.480	.531	.161	P25
5/16-18	.312	.600	.656	.198	P31
3/8-16	.375	.720	.781	.234	P31
1/2-13	.500	.872	.938	.251	P50
5/8-11	.625	1.112	1.188	.324	P62



*Penta-Plus™ has proven very successful for universities, electronics retail, and city government facilities.*

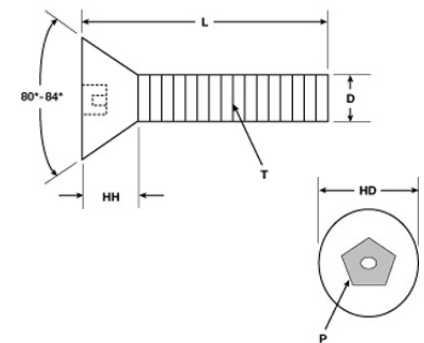
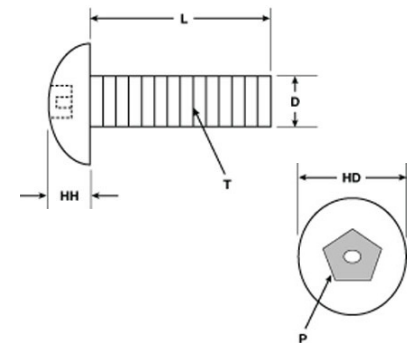

## PENTA-PLUS™ METRIC MACHINE SCREWS

### Button-Head Metric Machine Screws

NOM. Screw Size	Screw DIA. REF.	Head Diameter MM		Head Height MM		Drive Size REF.
		MAX	MIN	MAX	MIN	
M2x0.4	.077	4.4	4.0	1.4	1.0	P02
M2.5x0.45	.097	4.8	4.3	1.5	1.3	P04
M3x0.5	.118	5.7	5.4	1.65	1.43	P06
M4x0.7	.157	7.6	7.24	2.20	1.95	P08
M5x0.8	.196	9.5	9.14	2.75	2.5	P25
M6x1.0	.236	10.5	10.07	3.3	3.0	P25
M8x1.25	.315	14.0	13.57	4.4	4.05	P31
M10x1.5	.393	17.5	17.07	5.5	5.2	P37
M12x1.75	.472	21.0	20.48	6.6	6.24	P50
M16x2	.630	28.0	27.48	8.80	8.44	P62

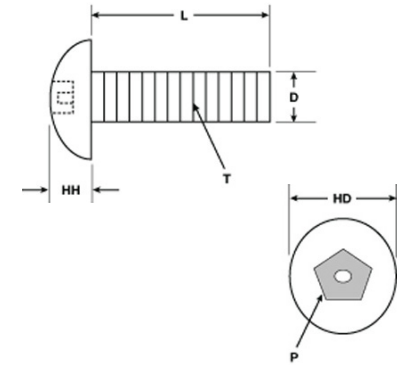

### Flat-Head Metric Machine Screws

NOM. Screw Size UNC.	Screw DIA. REF.	Head Diameter MM		Head Height MM		Drive Size REF.
		MAX	MIN	MAX	INCH	
M2x0.4	.077	4.3	3.6	1.2	.30	P02
M2.5x0.45	.097	5.9	4.7	1.5	.038-.045	P04
M3x0.5	.118	6.72	5.35	1.86	.047-.054	P06
M4x0.7	.157	8.00	7.00	2.48	.063-.071	P08
M5x0.8	.196	11.2	9.75	3.10	.079-.088	P25
M6x1.0	.236	13.5	11.7	3.72	.095-.104	P25
M8x1.25	.315	17.92	15.62	4.96	.126-.137	P31
M10x1.5	.393	22.4	19.5	6.20	.158-.170	P37
M12x1.75	.472	27	23.4	7.44	1.89-.203	P50
M16x2.0	.630	34	23	8.80	.244-.240	P62

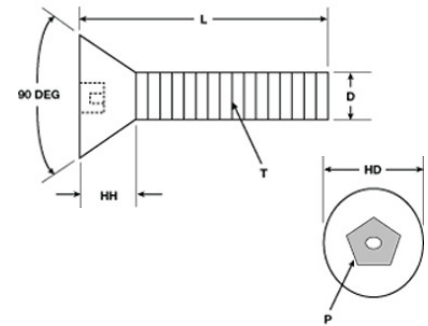

## PENTA-PLUS™ SELF-TAPPING SCREWS

### Button-Head Self-Tapping Screw

NOM. Screw Size AB Self-Tapping	Screw DIA. REF.	Head Diameter		Head Height		Drive Size REF.
		MAX	MIN	MAX	MIN	
2-32	.086	.086	.154	.046	.038	P02
4-24	.112	.213	.201	.059	.051	P04
6-20	.138	.262	.250	.073	.063	P06
8-19	.164	.312	.298	.087	.077	P08
10-16	.190	.361	.347	.101	.091	P25
12-14	.216	.396	.382	.116	.101	P25
14-14	.250	.437	.419	.132	.122	P25

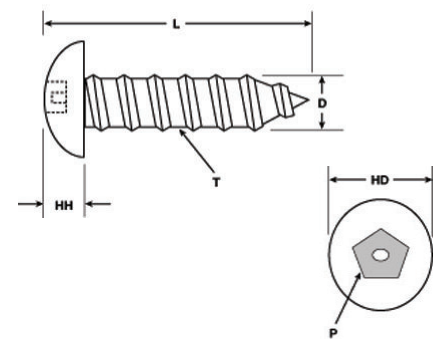

### Flat-Head Self-Tapping Screw

NOM. Screw Size AB Self-Tapping	Screw DIA. REF.	Head Diameter		Head Height		Drive Size REF.
		MAX	MIN	MAX	MIN	
2-32	.086	.197	.168	.067		P02
4-24	.112	.255	.218	.083		P04
6-20	.138	.307	.263	.097		P06
8-19	.164	.359	.311	.112		P08
10-16	.190	.411	.359	.127		P25
12-14	.216	.480	.411	.135		P25
14-14	.250	.531	.480	.161		P25

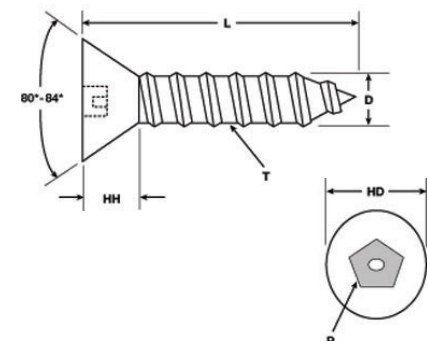

## **PENTA-PLUS™ MICRO SCREWS**

Micro Penta-Plus™ Machine screws are usually used in tamper-proof application in plastics. They often come with a blunt point and plastics threads. They can be power driven and can accept more torque than most other tamper-proof screws. They are available in smaller sizes than other tamper-resistant screws. They become an economical high-security tamper-proof screw that is the best micro tamper-resistant screw on the market.

**For details on your specific application please call.**